

Button Operation

MODE
LOCK

Dispensing Period

Press to set dispensing period
1~12 month

Automatic Lock Out Mode

Press for 2 seconds to unlock ()

POWER

Power ON/OFF

Press to Power unit On or Off

POWER + MODE
LOCK

Vibration Detection Mode

(Refer to Installation Guideline Step 7)

Hold the Power button and then
press the Mode button

TEST

Grease Capacity

Press to select 60ml/125ml/250ml

TEST Mode

ON : Press for 2 seconds

OFF : Short press of button

(will stop after completion of ongoing cycle)

RESET

Reset to default setting when
the unit malfunctions and/or after
changing the Service Pack

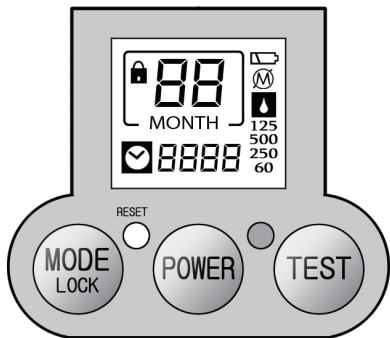

LCD Display



Dispensing period setting

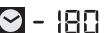

Remaining dispensing days



Automatic Lock Out mode





Grease pouch capacity



TEST mode

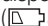



Number of days since the
dispensing period ended
( and  will also display)



Number of days operation has
been on hold due to excessive
backpressure



Maximum runtime has been
reached
( and  will also display)



Low battery power



Operation on hold due to
excessive backpressure



Dispensing period has
completed



LED blinks when battery is low,
excessive backpressure exists,
or grease level is empty

Mounting Methods

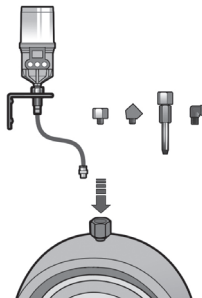

Single Point Installation

Direct Mount or Remote Installation using Extension Tubing

Direct mount is always preferable. For applications not allowing
any direct mounts, remotely mount the unit using appropriate
accessories and keep the distance from the lube point as short
as possible.

For remote installation using a tube, use a Ø6 (1/4") tube
pre-filled with the same or compatible grease as the grease
contained in the unit.

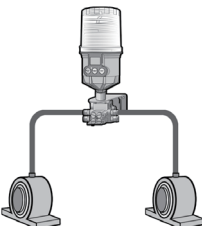

Multi-Point Installation

Multi-Point Remote Installation using Progressive Divider Block

Ensure the break-off pressure is below the average operating
pressure of 30bar (435psi).

Warning

- ▶ Do not block any ports on divider block and use a divider
block corresponding to the number of ports required for
multi-point installation.
- ▶ For more information, please refer to the Multi-Point
Remote Installation user manual.

Precautions

Wiring : The cable from the vibration detector should not touch the motor directly. Adjust the
cable length and position using a tie band if necessary.

Regular Inspection : Keep the orientation of the vibration detector vertical. When performing
periodic maintenance checks, re-run Vibration Detection Mode to ensure vibration is correctly
being detected. Adjust position of sensor box and sensitivity as needed.

Replace Service Pack after the Recommended Use Time : If  appears on the
LCD after 2 years (250ml : 1 year and 6 months) from the installation date, replace the service
pack immediately even if the grease remains in the pouch. (Dispensing failure may occur after long
periods of time due to grease hardening and/or drops in battery voltage.)

Rev.03 02/21



CHESTERTON®
Global Solutions, Local Service.

A.W. Chesterton Company

860 Salem Street, Groveland, MA 01834, USA

© 2019 A.W. Chesterton Company.

© Registered trademark owned and licensed by A.W. Chesterton Company
in USA and other countries, unless otherwise noted. www.chesterton.com

A.W. Chesterton Company makes no representations or warranties with respect to the
completeness or accuracy of the data or information contained herein. A.W. Chesterton does
not assume any liability for any losses or damages resulting from the use or application of the
data or information contained herein. Application conditions may influence the outcome of
the usage of the product. For specific guidance concerning usage and application conditions,
please contact Application Engineering at A.W. Chesterton.



User Manual

LUBRI-CUP™ EM-VS
Series
(60ml / 125ml / 250ml)

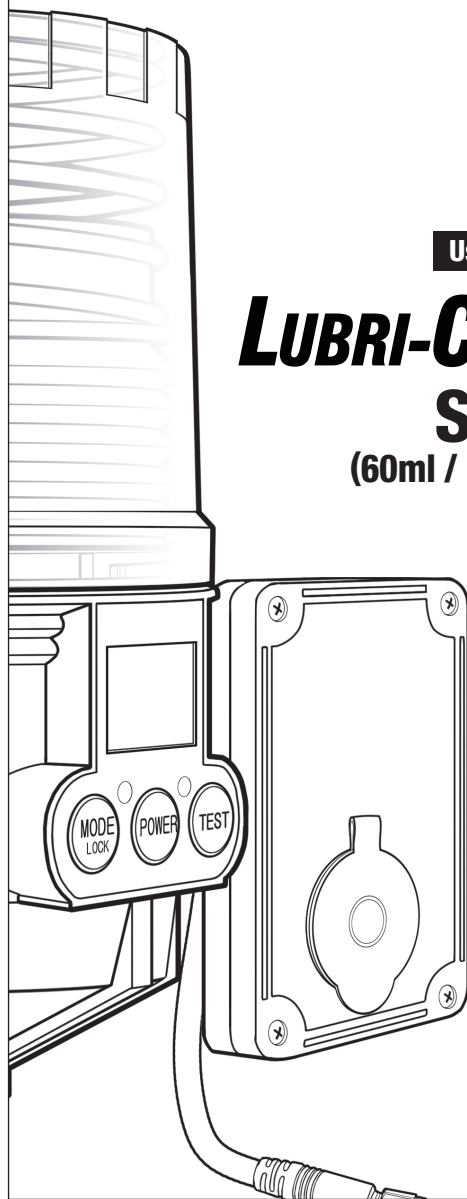

Form no. EN350538

Product Details

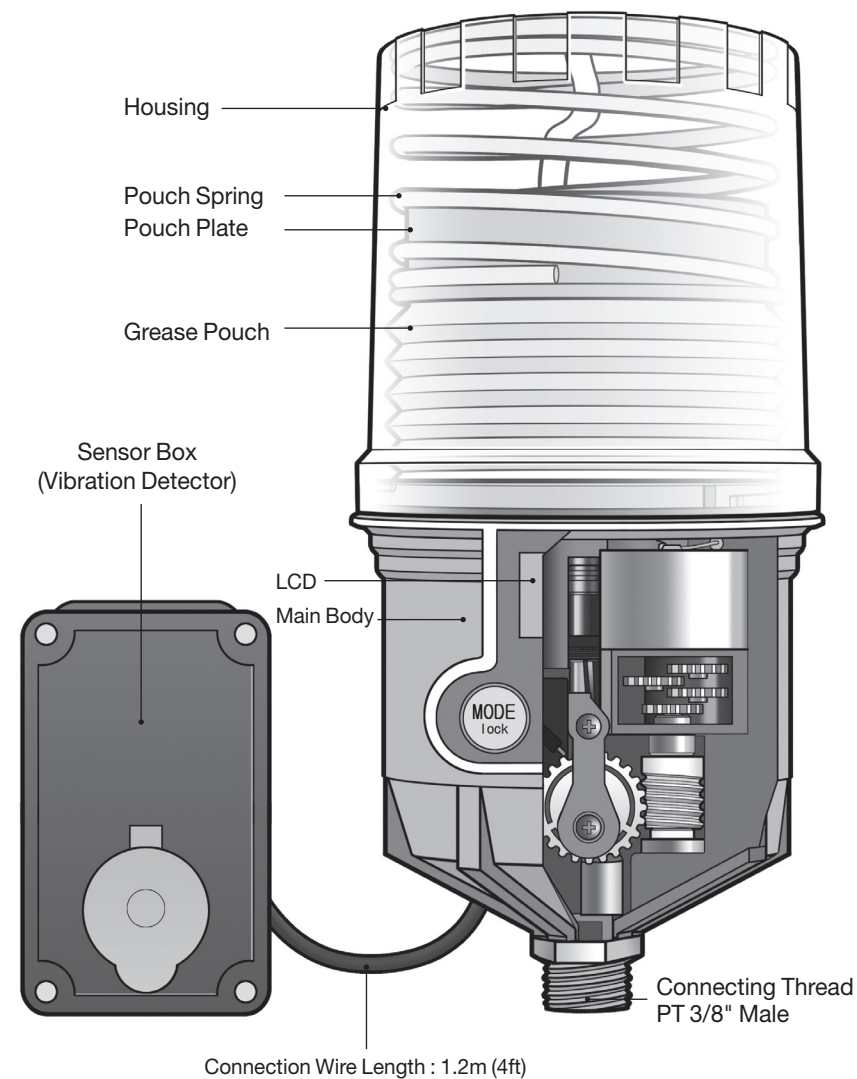

Installation Guidelines

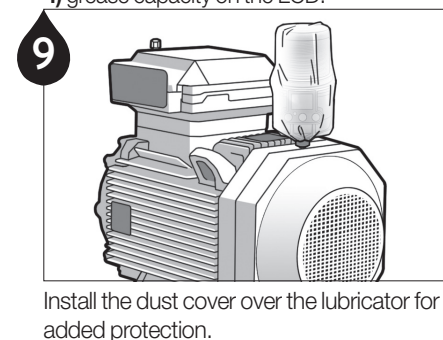
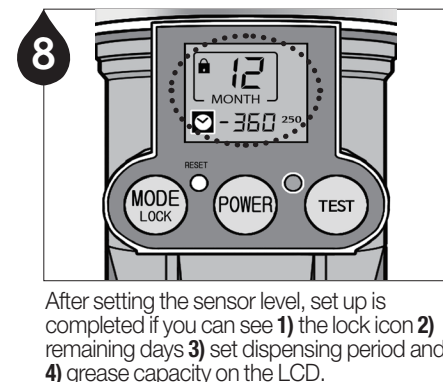
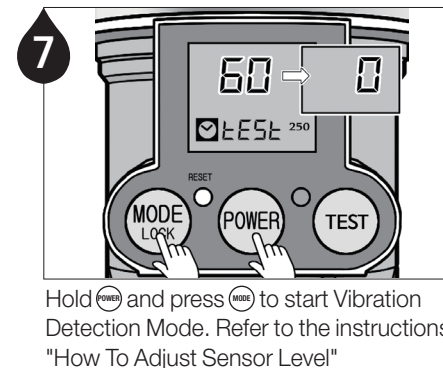
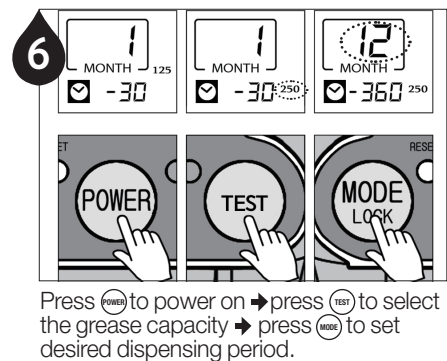
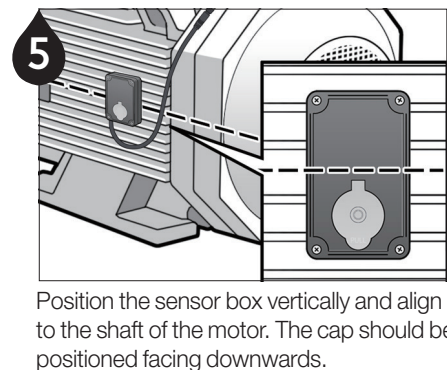
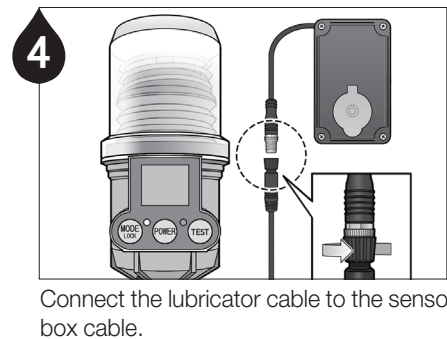
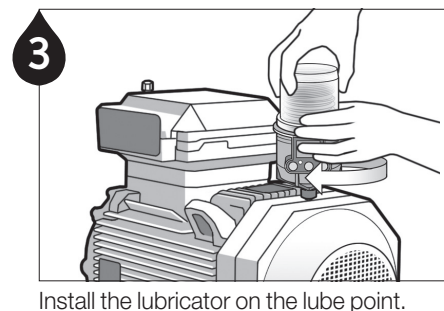
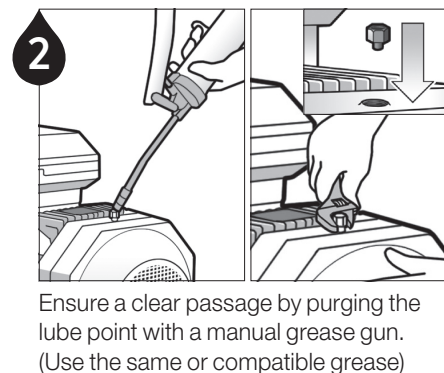
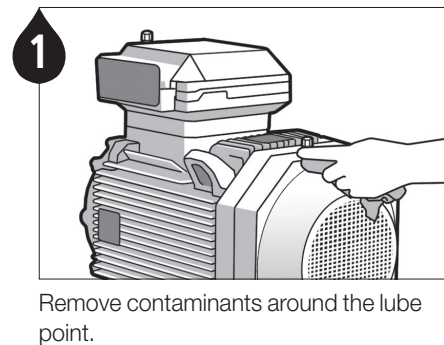

How To Adjust Sensor Level

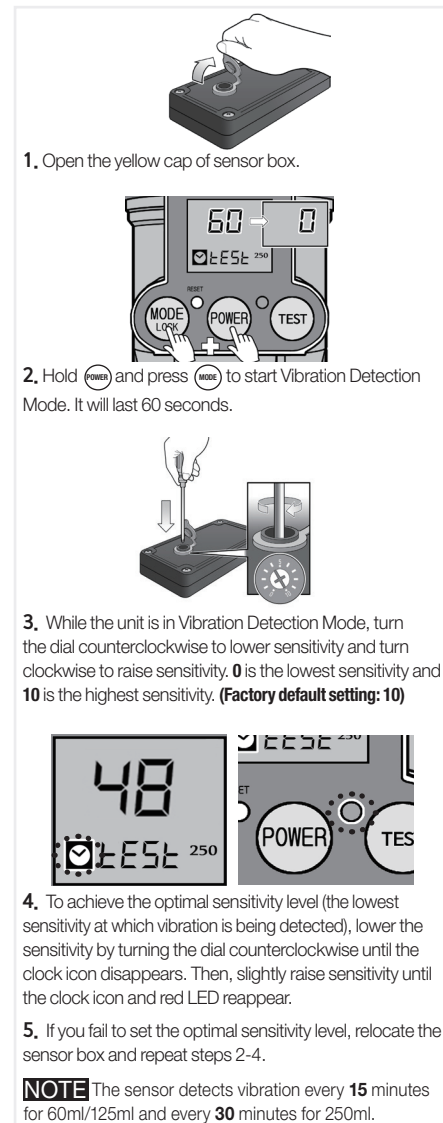

LCD Display During Proper Synchronization

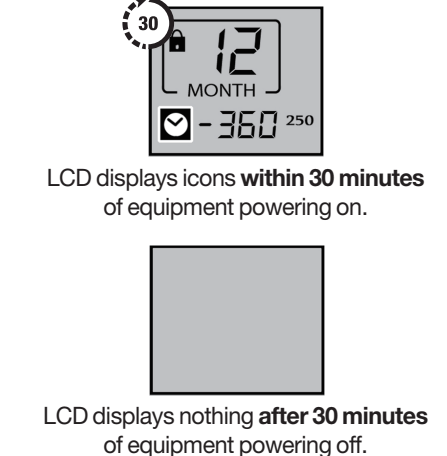

LCD Display During Improper Synchronization

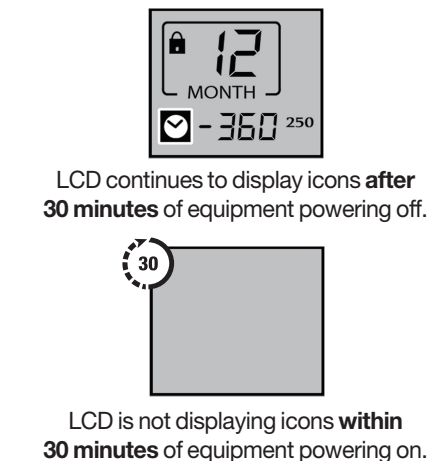

NOTE If the unit is not operating in synchronization properly, adjust and/or relocate the sensor box. If the problem persists, contact your local distributor or sales rep.

How To Replace Service Pack

